



00

Claremont Terraces

landscape concept





CONTENTS

- 01 CONTEXT & SITE ANALYSIS
- 02 CONCEPT IMAGERY
- 03 LANDSCAPE CONCEPT
- 04 PLANTING PALETTE
- 05 DEEP SOIL & TREE CANOPY PROVISION COMPLIANCE

01

CONTEXT & SITE ANALYSIS





Claremont terraces stage 2 is located within the City of Claremont, in the suburb of Claremont.

The site sits within a rapidly developing residential area surrounding the Revo Fitness Stadium Oval, situated north of the train line and near Claremont Train Station. Existing residential developments have already been constructed around the oval, with Claremont Terraces Stage 1 currently under construction immediately to the west of Stage 2.

A range of key public amenities are within walking distance, including Lake Claremont, Claremont Quarter, Claremont Train Station, and the Claremont Showgrounds. Both the Revo Fitness Stadium Oval and Showgrounds host occasional events throughout the year.

In addition to residential apartments, the area around the oval features the Revo Fitness Gym, IGA supermarket, cafés, and several other local organisations and businesses. Across Davies Road, opposite the oval, lies the Claremont Aquatic Centre, which includes the Claremont Pool.

The site is conveniently located within easily accessible commuting distance to the coast, Swan River, and CBD.



CLAREMONT TERRACES STAGE 2

PREPARED FOR HILLAM ARCHITECTS

LANDSCAPE CONCEPT
MARCH 2026

JOB NO. 2514601 C1.104

REV E

COPYRIGHT THIS DOCUMENT IS AND SHALL REMAIN THE PROPERTY OF PLANE

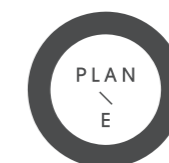

LANDSCAPE ARCHITECTS

LEVEL 1 278 RAILWAY PARADE WEST LEEDERVILLE 6007
T: (08) 9388 9566 E: mail@plane.com.au

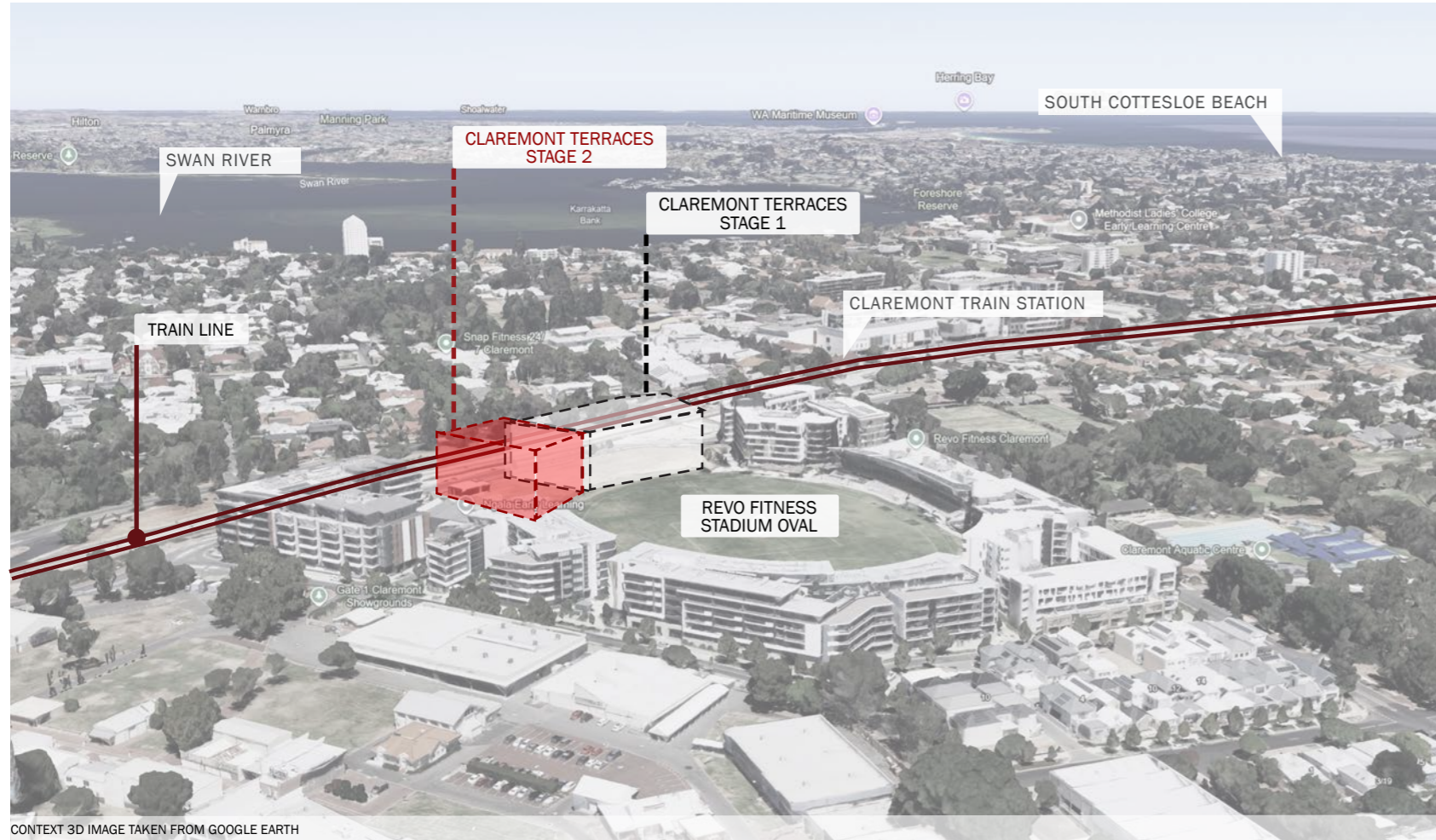

CONTEXT 3D IMAGE TAKEN FROM GOOGLE EARTH



PHOTO TAKEN FROM OVAL TOWARDS CLAREMONT TERRACES STAGE 1 AND 2 (SOUTH-EAST DIRECTION)



PHOTO TAKEN AT PATH ACCESS INTO OVAL, WEST OF CLAREMONT TERRACES STAGE 1



PHOTO TAKEN AT TIGER WAY, EXISTING PLATANUS ACERIFOLIA AS STREET TREE (NORTH-WEST DIRECTION)



PHOTO TAKEN AT SHENTON ROAD (NORTH-EAST DIRECTION)

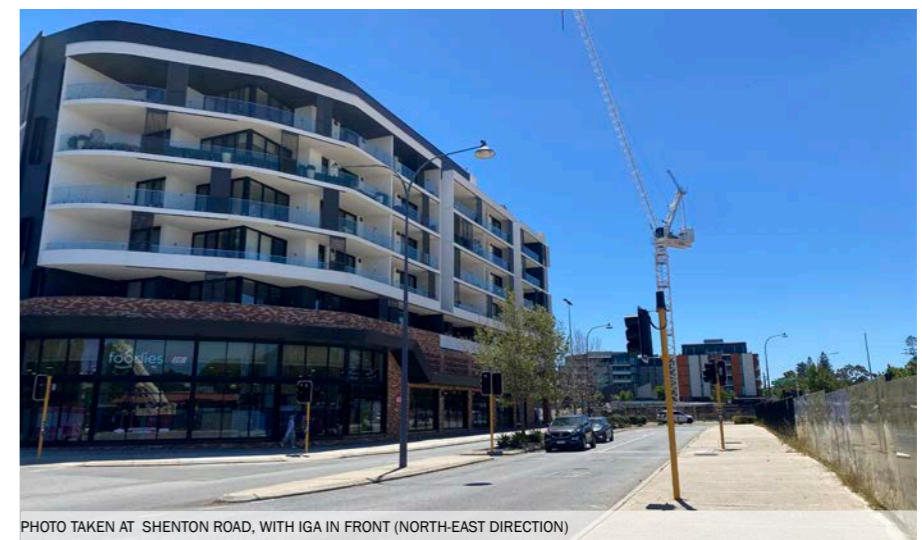

PHOTO TAKEN AT SHENTON ROAD, WITH IGA IN FRONT (NORTH-EAST DIRECTION)

CLAREMONT TERRACES STAGE 2

PREPARED FOR HILLAM ARCHITECTS

LANDSCAPE CONCEPT
MARCH 2026

JOB NO. 2514601 C1.105

REV E

COPYRIGHT THIS DOCUMENT IS AND
SHALL REMAIN THE PROPERTY OF
PLAN E

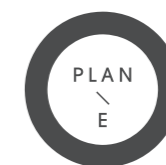

LANDSCAPE ARCHITECTS

LEVEL 1 278 RAILWAY PARADE WEST LEEDERVILLE 6007
T: (08) 9388 9566 E: mail@plane.com.au

02-03

IMAGERY & LANDSCAPE CONCEPT

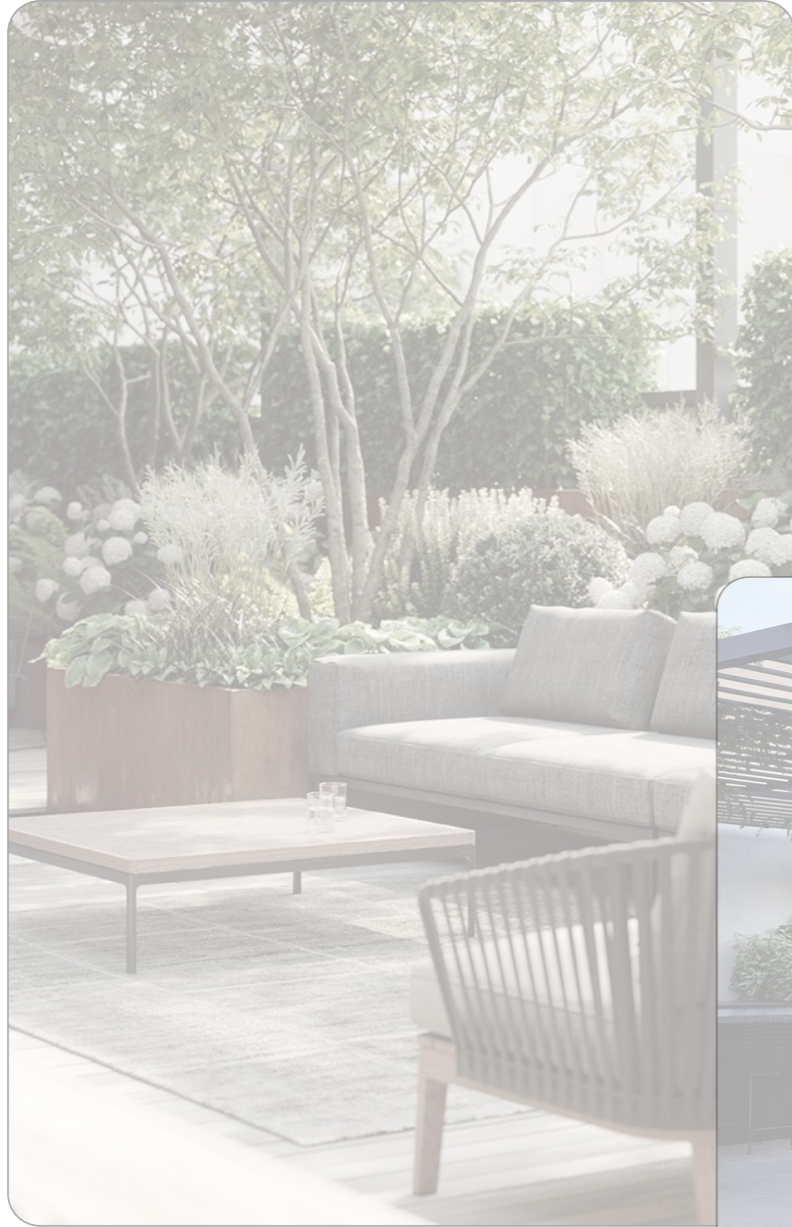



CLAREMONT TERRACES STAGE 2

PREPARED FOR HILLAM ARCHITECTS

LANDSCAPE CONCEPT
MARCH 2026

JOB NO. 2514601 C1.107

REV E

COPYRIGHT THIS DOCUMENT IS AND
SHALL REMAIN THE PROPERTY OF
PLAN E

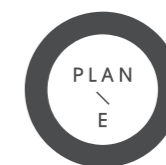

LANDSCAPE ARCHITECTS

LEVEL 1 278 RAILWAY PARADE WEST LEEDERVILLE 6007
T: (08) 9388 9566 E: mail@plane.com.au

03

LANDSCAPE CONCEPT BASEMENT LEVEL

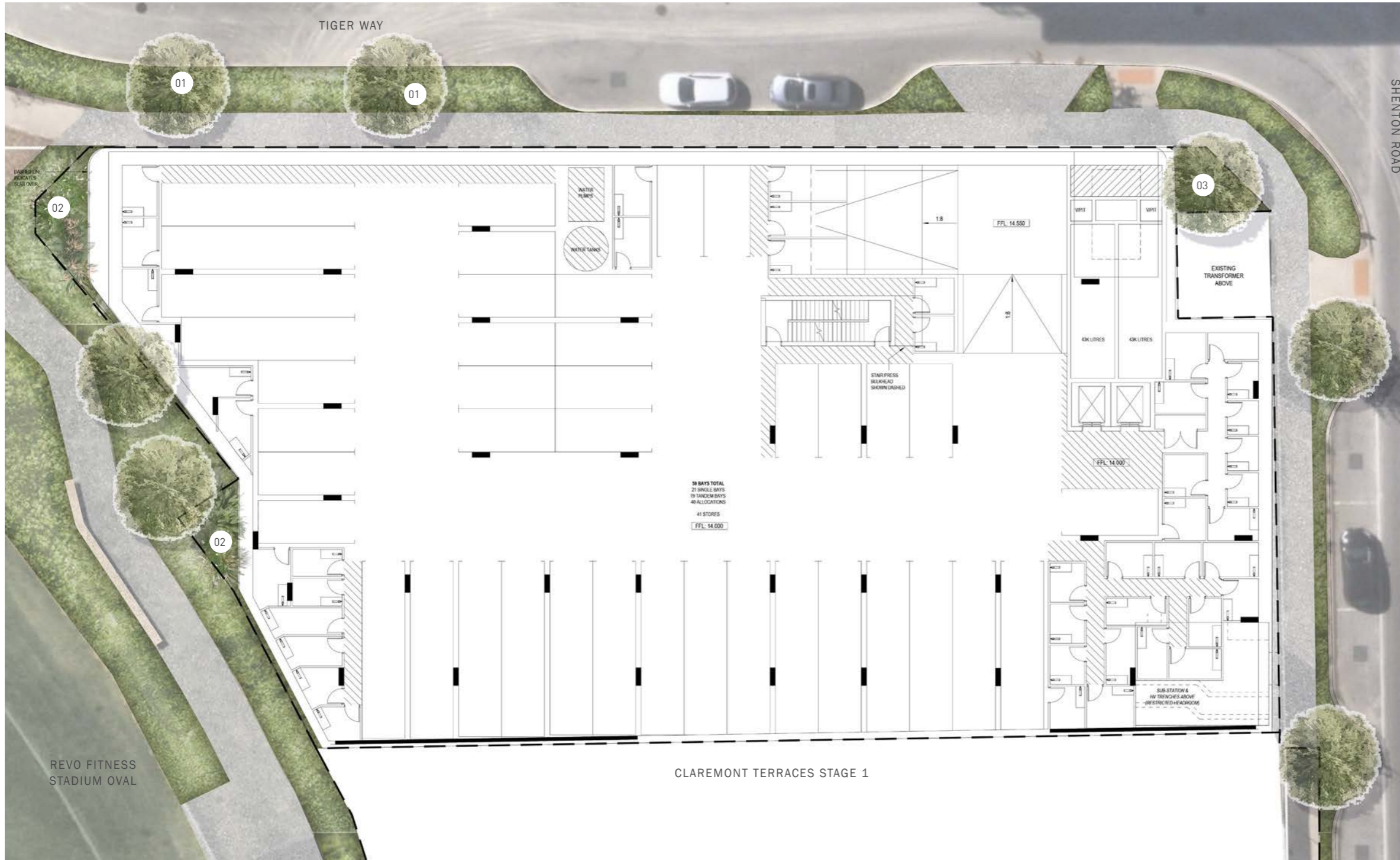

LEGEND

- 01 PROPOSED RELOCATION OF EXISTING TREES
- 02 DYNAMIC FEATURE PLANTING TO BUILDING THAT TIES IN WITH SURROUNDING PLANTING
- 03 DYNAMIC FEATURE PLANTING AND TREE TO SCREEN EXISTING TRANSFORMER FROM THE CORNER OF THE BUILDING

CLAREMONT TERRACES STAGE 2 PREPARED FOR HILLAM ARCHITECTS

LANDSCAPE CONCEPT
MARCH 2026

JOB NO. 2514601
1:500 @ A3

C1.108
0 5 10 15 25m
REV E

COPYRIGHT THIS DOCUMENT IS AND
SHALL REMAIN THE PROPERTY OF
PLAN E

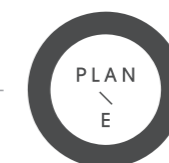

LANDSCAPE ARCHITECTS

LEVEL 1 278 RAILWAY PARADE WEST LEEDERVILLE 6007
T: (08) 9388 9566 E: mail@plane.com.au



LEGEND

- 01 DYNAMIC FEATURE PLANTING TO BUILDING THAT TIES IN WITH SURROUNDING PLANTING

CLAREMONT TERRACES STAGE 2

PREPARED FOR HILLAM ARCHITECTS

LANDSCAPE CONCEPT
MARCH 2026

JOB NO. 2514601
1:500 @ A3

C1.109
0 5 10 15 25m
REV E

COPYRIGHT THIS DOCUMENT IS AND
SHALL REMAIN THE PROPERTY OF
PLANE

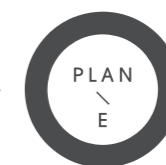

LANDSCAPE ARCHITECTS

LEVEL 1 278 RAILWAY PARADE WEST LEEDERVILLE 6007
T: (08) 9388 9566 E: mail@plane.com.au

03

LANDSCAPE CONCEPT LEVEL 1

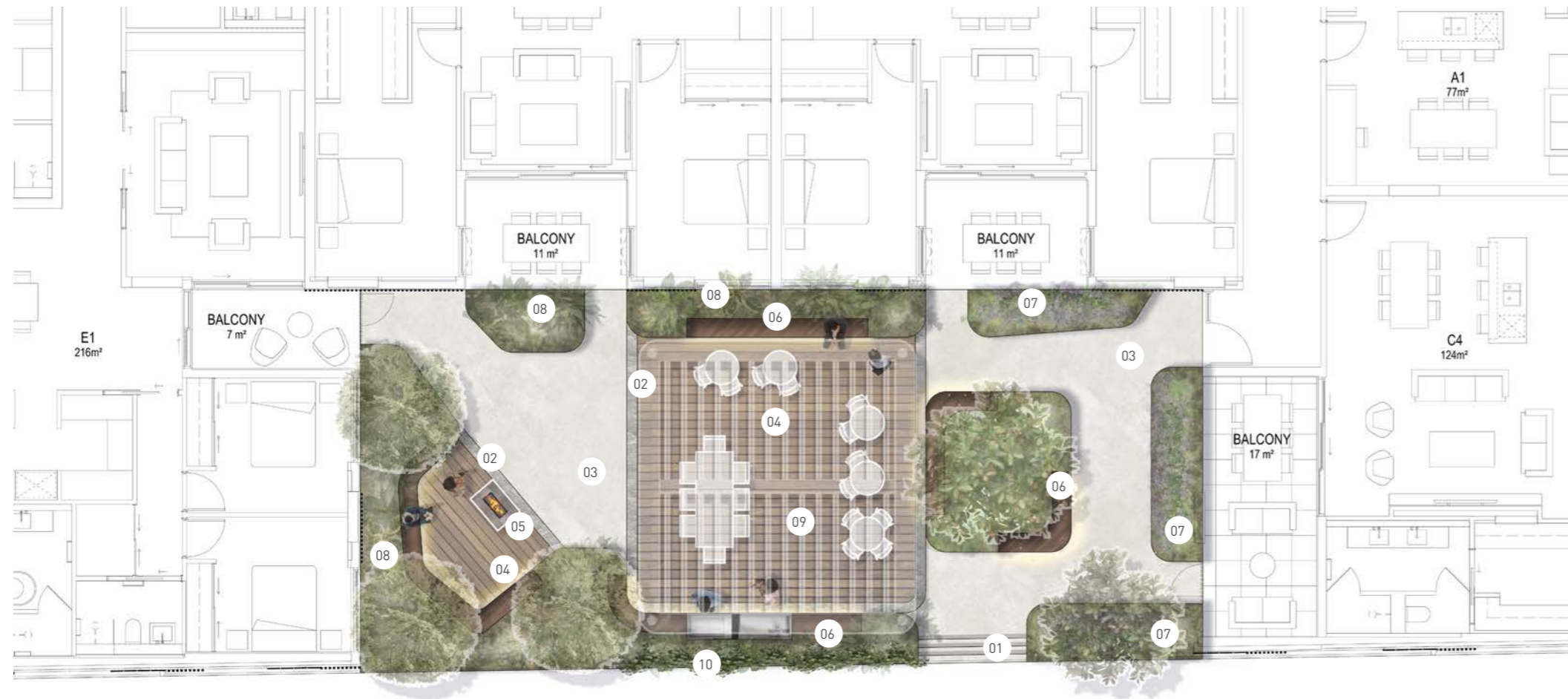

LEGEND

- 01 STAIRS TO PROVIDE CONNECTION AND ACCESS TO STAGE 1 BUILDING LEVEL 1 COURTYARD
- 02 FEATURE PAVEMENT BANDING STRIP
- 03 PROPOSED FEATURE UNIT PAVING
- 04 PROPOSED TIMBER LOOK TILE TO FOCAL SEATING ZONE & DINING AREA
- 05 FIRE PIT SURROUNDED BY PROPOSED BUILT-IN TIMBER BENCH SEAT NESTLED INTO GARDEN BED
- 06 PROPOSED BUILT-IN TIMBER BENCH SEATS NESTLED INTO HERBAL GARDEN BED WITH FRUIT TREE
- 07 HERBAL GARDEN BED PLANTERS
- 08 RAISED STEEL PLANTERS WITH SHADE TOLERANT PLANT SPECIES SUITED TO LOW LIGHT CONDITIONS
- 09 COMMUNAL DINING AREA WITH FLEXIBLE SEATING, BUILT-IN TIMBER SEATS INTO GARDEN BEDS, BBQ AND PERGOLA
- 10 CLIMBERS TO PROVIDE SHADE PROTECTION AND SCREENING

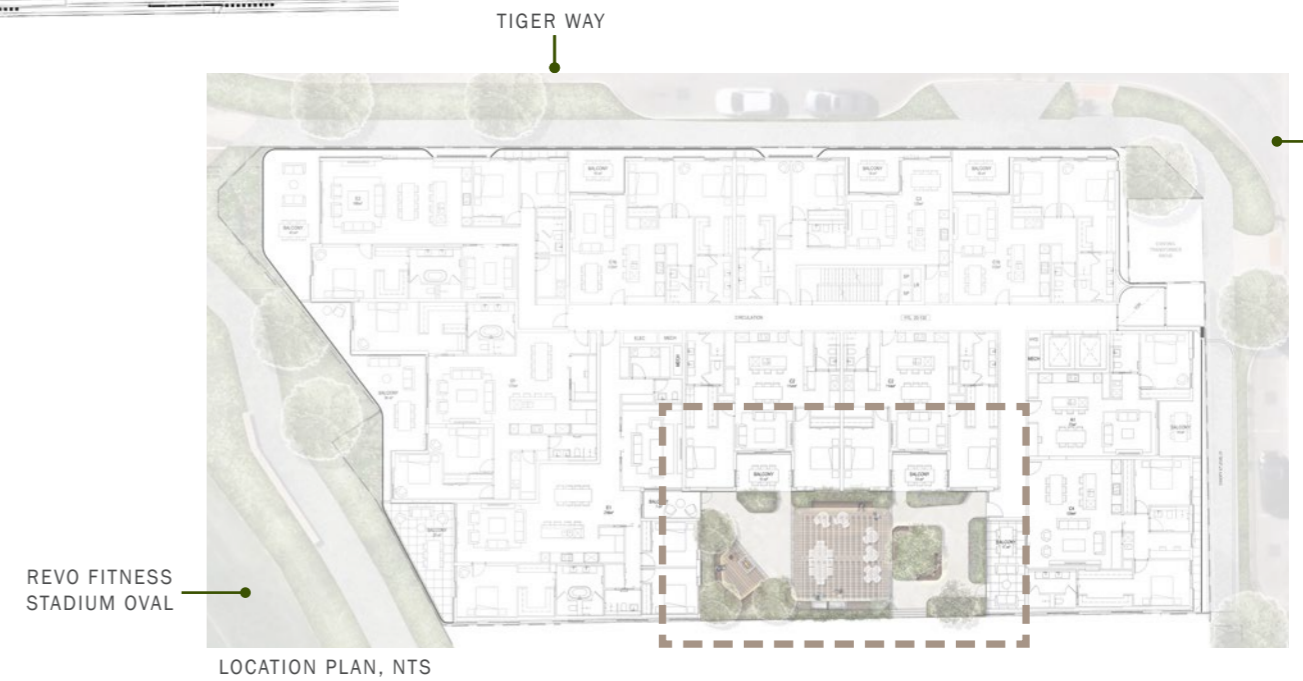

CLAREMONT TERRACES STAGE 2

PREPARED FOR HILLAM ARCHITECTS

LANDSCAPE CONCEPT
MARCH 2026

JOB NO. 2514601
1:300 @ A3

C1.1010
0 3 6 9 15m
REV E

COPYRIGHT THIS DOCUMENT IS AND SHALL REMAIN THE PROPERTY OF PLAN E

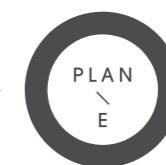

LANDSCAPE ARCHITECTS

LEVEL 1 278 RAILWAY PARADE WEST LEEDERVILLE 6007
T: (08) 9388 9566 E: mail@plane.com.au

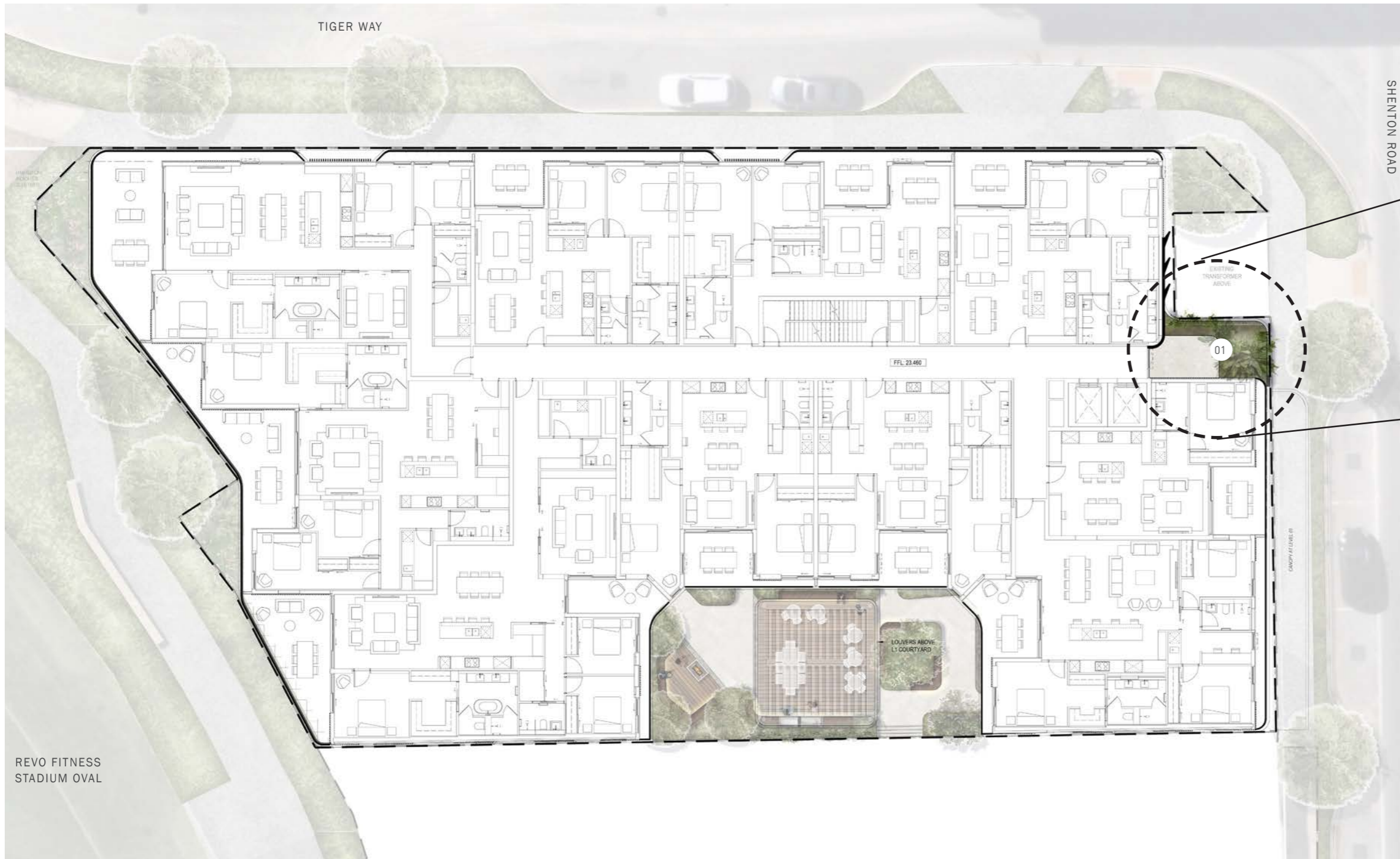

LEGEND

- 01 PROPOSED FEATURE PLANTING WITH CREEPERS HANGING FROM LEVEL 2 TERRACE

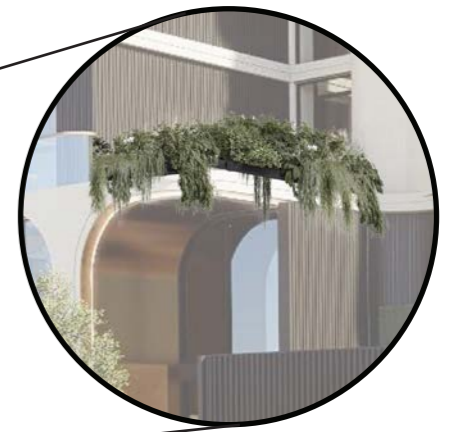

DETAIL 1: CREEPERS HANGING DOWN OVER LOBBY ENTRANCE FROM LEVEL 2.

CLAREMONT TERRACES STAGE 2

PREPARED FOR HILLAM ARCHITECTS

LANDSCAPE CONCEPT
MARCH 2026

JOB NO. 2514601
1:500 @ A3

C1.1011
0 5 10 15 25m
REV E

COPYRIGHT THIS DOCUMENT IS AND SHALL REMAIN THE PROPERTY OF PLAN E

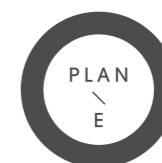

LANDSCAPE ARCHITECTS

LEVEL 1 278 RAILWAY PARADE WEST LEEDERVILLE 6007
T: (08) 9388 9566 E: mail@plane.com.au

03

LANDSCAPE CONCEPT ROOF TOP LEVEL



LEGEND

- 01 FEATURE PAVEMENT BANDING STRIP
- 02 PROPOSED FEATURE UNIT PAVING
- 03 PROPOSED TIMBER LOOK TILE TO DEFINE DINING/BAR & LOUNGE AREAS - AS WELL AS YOGA DECK & ENTRY HALLWAY
- 04 BAR TABLE WITH BAR STOOLS LOOKING OUT TO THE REVO FITNESS OVAL
- 05 BAR TABLE WITH BAR STOOLS OVERLOOKING THE CITY & SWAN RIVER
- 06 FIRE PIT SURROUNDED BY FLEXIBLE LOUNGE FURNITURE OR BUILT-IN TIMBER SEATS INTO GARDEN BED
- 07 PROPOSED BUILT-IN TIMBER BENCH SEATS NESTLED INTO GARDEN BED
- 08 COMMUNAL DINING AREA WITH FLEXIBLE SEATING, BUILT-IN TIMBER SEATS INTO GARDEN BED, BBQ, SHELVES/DROP-OFF SHELF & PERGOLA OVER HEAD
- 09 HERBAL GARDEN BED PLANTER
- 10 POTS TO SOFTEN & DEFINE EDGES
- 11 PRIVATE ROOF TOP AREA WITH BBQ, ROOF PAVILION, SHELVES/DROP-OFF SHELF & FLEXIBLE SEATING OPTIONS
- 12 YOGA DECK & PAVILION
- 13 CLIMBERS GROWING UP ALONG THE FACADE

CLAREMONT TERRACES STAGE 2

PREPARED FOR HILLAM ARCHITECTS

LANDSCAPE CONCEPT
MARCH 2026

JOB NO. 2514601
1:500 @ A3

C1.1012
0 5 10 15 25m
REV E

COPYRIGHT THIS DOCUMENT IS AND SHALL REMAIN THE PROPERTY OF PLAN E

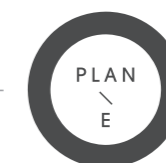

LANDSCAPE ARCHITECTS

LEVEL 1 278 RAILWAY PARADE WEST LEEDERVILLE 6007
T: (08) 9388 9566 E: mail@plane.com.au

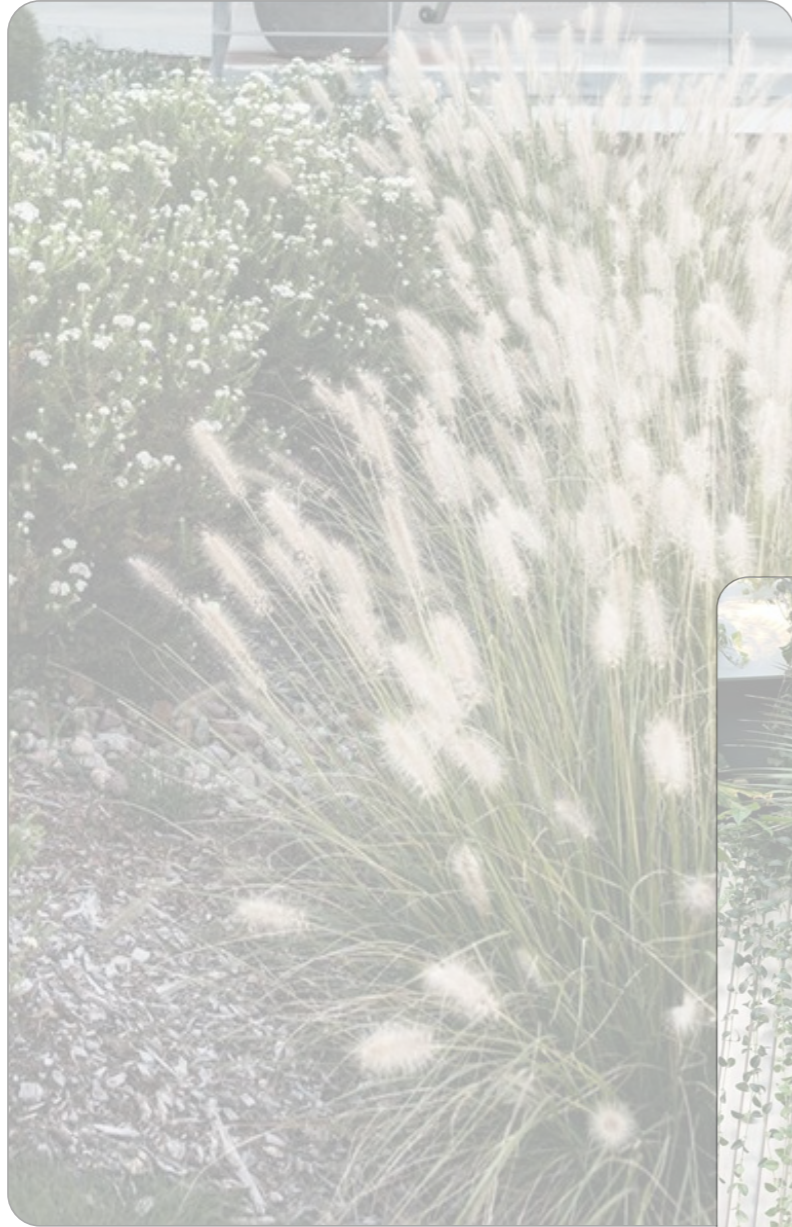

04-05

PLANTING PALETTE, DEEP SOIL & TREE CALCULATION



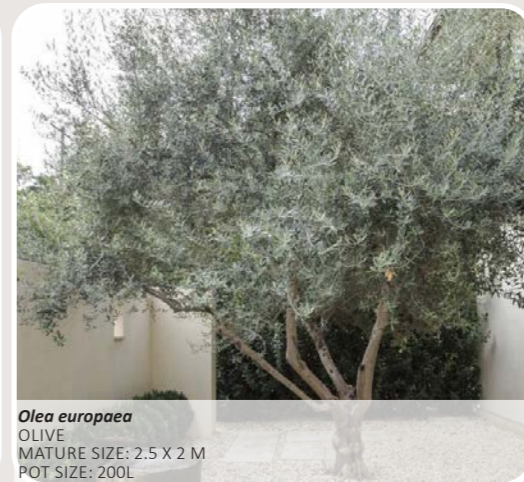
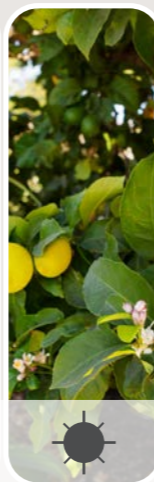
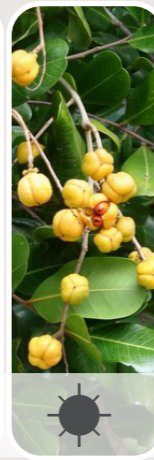

SUN/HALF SUN PLANTS



Lomandra katrinus deluxe
ALOE SPINY HEADED MAT BUSH
MATURE SIZE: 1 X 0.7 M
SPACING: 2/M² POT SIZE: 140MM



Olearia 'Beach ball'
COAST DAISY BUSH
MATURE SIZE: 0.4 X 0.8 M
SPACING: 2/M² POT SIZE: 140 MM



Anigozanthos Everlasting Red
KANGAROO PAW
MATURE SIZE: 0.45 X 0.35 M
SPACING: 1/M² POT SIZE: 140 MM



Grevillea 'Gin Gin Gem'
SPIDER FLOWER
MATURE SIZE: 0.3 X 2 M
SPACING: 2/M² POT SIZE: 140 MM



Dianella 'Tasred'
FLAX LILY
MATURE SIZE: 0.45 X 0.5 M
SPACING: 3/M² POT SIZE: 140 MM



Lomandra 'Lime Tuff'
MAT RUSH
MATURE SIZE: 0.5 X 0.5 M
SPACING: 4/M² POT SIZE: 140 MM



Eremophila Kalbarri Carpet
EMU BUSH
MATURE SIZE: 0.2 X 2 M
SPACING: 2/M² POT SIZE: 140 MM



Senecio Serpens
BLUE CHALK STICKS
MATURE SIZE: 0.3 X 0.9 M
SPACING: 2/M² POT SIZE: 140 MM



Casuarina 'Cousin it'
COUSIN IT CASUARINA
MATURE SIZE: 0.15 X 1 M
SPACING: 2/M² POT SIZE: 140 MM

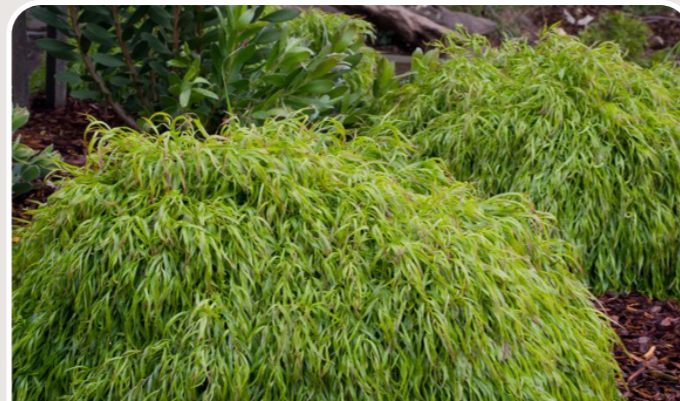

Acacia cognata 'Limelight'
RIVER WATTLE
MATURE SIZE: 0.7 X 1.2 M
SPACING: 2/M² POT SIZE: 140 MM



Dichondra 'Silver falls'
KIDNEY WEED
MATURE SIZE: 0.1 X 2 M
SPACING: 4/M² POT SIZE: 140 MM

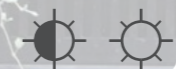

Hardenbergia comptoniana
NATIVE WISTERIA
MATURE SIZE: 3 X 3 M
SPACING: 2/M² POT SIZE: 140 MM



SUN/HALF SUN PLANTS



HERBAL GARDEN PLANTS



SHADE TOLERANT SPECIES



Asplenium nidus
BIRDS NEST FERN
MATURE SIZE: 1 X 1.5 M
SPACING: 2/M² POT SIZE: 140 MM



Chamaedorea seifritzii
BAMBOO PALM
MATURE SIZE: 3 X 2 M
SPACING: 1/M² POT SIZE: 140 MM



Philodendron Xanadu
XANADU
MATURE SIZE: 0.9 X 0.7 M
SPACING: 2/M² POT SIZE: 140 MM



Fatsia japonica
JAPANESE ARALIA
MATURE SIZE: 1-6 X 1-4 M
SPACING: 1/M² POT SIZE: 140 MM



Kalanchoe bracteata
KALANCHOE SILVER TEASPOONS
MATURE SIZE: 1 X 1 M
SPACING: 2/M² POT SIZE: 140 MM



Spathiphyllum sensation
PEACE LILY
MATURE SIZE: 1 X 1 M
SPACING: 2/M² POT SIZE: 5 L

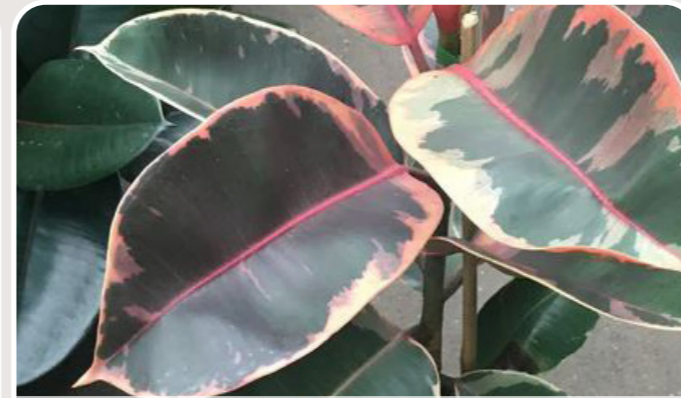

Ficus Tineke
FICUS
MATURE SIZE: 0.3 X 0.2 M
SPACING: 2/M² POT SIZE: 140 MM



Arthropodium cirratum
NEW ZEALAND ROCK LILY
MATURE SIZE: 0.8 X 0.8 M
SPACING: 2/M² POT SIZE: 140 MM



Blechnum 'Silver Lady'
SILVER LADY FERN
MATURE SIZE: 1.2 X 1 M
SPACING: 2/M² POT SIZE: 140 MM



Philodendron Paraiso Verde
VARIEGATED PHILODENDRON
MATURE SIZE: 3 X 0.6 M
SPACING: 3/M² POT SIZE: 140 MM



Dichondra repens
KIDNEY PLANT
MATURE SIZE: 0.1 X 0.3 M
SPACING: 5/M² POT SIZE: 140 MM



Dieffenbachia Tropic Marianne
DIEFFENBACHIA
MATURE SIZE: 1.5 X 0.6 M
SPACING: 2/M² POT SIZE: 140 MM





ITEM 3.3A - MINIMUM DEEP SOIL AREA AND TREE PROVISION

REQUIRED DEEP SOIL AREA: **200.3 SQ.M** / BASED ON A SITE AREA OF **2003 SQ.M (10%)**

REQUIRED TREE PROVISION: **2 x LARGE TREE IN DEEP SOIL** BASED ON A SITE AREA OF **2003 SQ.M**

DEEP SOIL AREA PROVISION REQUIREMENTS - TABLE 01

THE DEVELOPMENT PROVIDES COMPLIANT TREE PROVISION IN DEEP SOIL ON GROUND.

THE TABLE BELOW OUTLINES MINIMUM REQUIREMENTS FOR DEEP SOIL AREAS AS DEFINED IN DESIGNWA.

TABLE 01: DEEP SOIL ZONE REQUIREMENTS			
	LOT AREA: 2003 SQ.M	MINIMUM REQUIREMENTS	PROJECT REQUIREMENT FOR PROVISION
WAPC DEEP SOIL AREA REQUIREMENTS	>1000 SQ.M	10% OF DEEP SOIL AREA ON SITE (200.3 SQ.M)	PROVIDED DEEP SOIL AREA OF 39 SQ.M PROVIDED ADDITIONAL PLANTING ON STRUCTURE 268 SQ.M (REQUIRED 322.6 SQ.M)

DEEP SOIL AREA AND PLANTING ON STRUCTURE PROVISION - TABLE 02

THE DEVELOPMENT EXCEEDS THE DEEP SOIL AREA AND OFFSET REQUIREMENTS.

TABLE 02: DEEP SOIL AREAS AND PLANTING ON STRUCTURE			
	DEEP SOIL IN GROUND (more than 1m)	ON STRUCTURE PLANTING	TOTAL
BASMENT LEVEL	39 SQ.M	- SQ.M	39 SQ.M
GROUND FLOOR	- SQ.M	7 SQ.M	7 SQ.M
LEVEL 1	- SQ.M	60 SQ.M	60 SQ.M
LEVEL 2	- SQ.M	11 SQ.M	11 SQ.M
ROOF TOP LEVEL	- SQ.M	151 SQ.M	151 SQ.M

THE TABLE BELOW OUTLINES MINIMUM REQUIREMENTS FOR TREE PROVISION AS DEFINED IN DESIGNWA.

TABLE 03: TREE PROVISION REQUIREMENTS			
	LOT AREA: 4200 SQ.M	MINIMUM REQUIREMENTS	PROJECT REQUIREMENT FOR PROVISION
WAPC TREE CANOPY REQUIREMENTS	>1000 SQ.M	2 LARGE TREE AND SMALL TREES TO SUIT AREA	MINIMUM OF 128 SQ.M OF TREE CANOPY COVER PROVIDED 532 SQ.M TREE CANOPY COVER

THE DEVELOPMENT EXCEEDS THE TREE PROVISION REQUIREMENTS.

TABLE 04: TREE PROVISION				
	SMALL TREES: 2-6m DIAMETER	MEDIUM TREES: 6-9m DIAMETER	LARGE TREES: >9m DIAMETER	TOTAL CANOPY COVER (NOT INCLUDING EXISTING TREES)
BASMENT LEVEL	1 28 SQ.M CANOPY COVER AT MATURITY	- 64 SQ.M CANOPY COVER AT MATURITY	- 64 SQ.M CANOPY COVER AT MATURITY	28 SQ.M
GROUND FLOOR	-	-	-	-
LEVEL 1	4	-	-	112 SQ.M
LEVEL 2	1	-	-	28 SQ.M
ROOF TOP LEVEL	13	-	-	364 SQ.M

IRRIGATION STRATEGY

A FULLY AUTOMATIC IRRIGATION SYSTEM WILL BE INSTALLED FOR THE CLAREMONT TERRACES STAGE 2 PROJECT. THE SCOPE WILL INCLUDE:

- IRRIGATION TO ALL LANDSCAPE AREAS
- MOISTURE SENSORS THROUGHOUT, TO ENSURE WATER USE IS MINIMISED
- USE OF LOW WATER USE EMITTERS TO ENSURE ONLY SUFFICIENT WATER IS PROVIDED TO IRRIGATE PLANTING AREAS
- IN-LINE FERTILISATION UNIT TO ENSURE FERTILISING AND MOISTURE RETENTION IS CONTROLLED
- USE OF POP - UP FLOOD BUBBLERS TO SUIT SIZE OF GARDEN BEDS TO ENSURE ANY OVER-SPRAY AND WASTAGE IS MITIGATED, AND;
- A DETAILED DESIGN AND SPECIFICATION WILL BE PROVIDED AT BUILDING LICENSE APPLICATION STAGE.

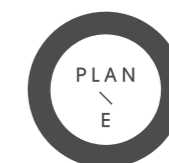

05

DEEP SOIL & TREE CANOPY PROVISION COMPLIANCE GROUND FLOOR & LEVEL 1

FIGURES SHOWING DEEP SOIL REQUIREMENTS FOR TREES (AS PER SPP 7.3 DESIGN GUIDELINES)

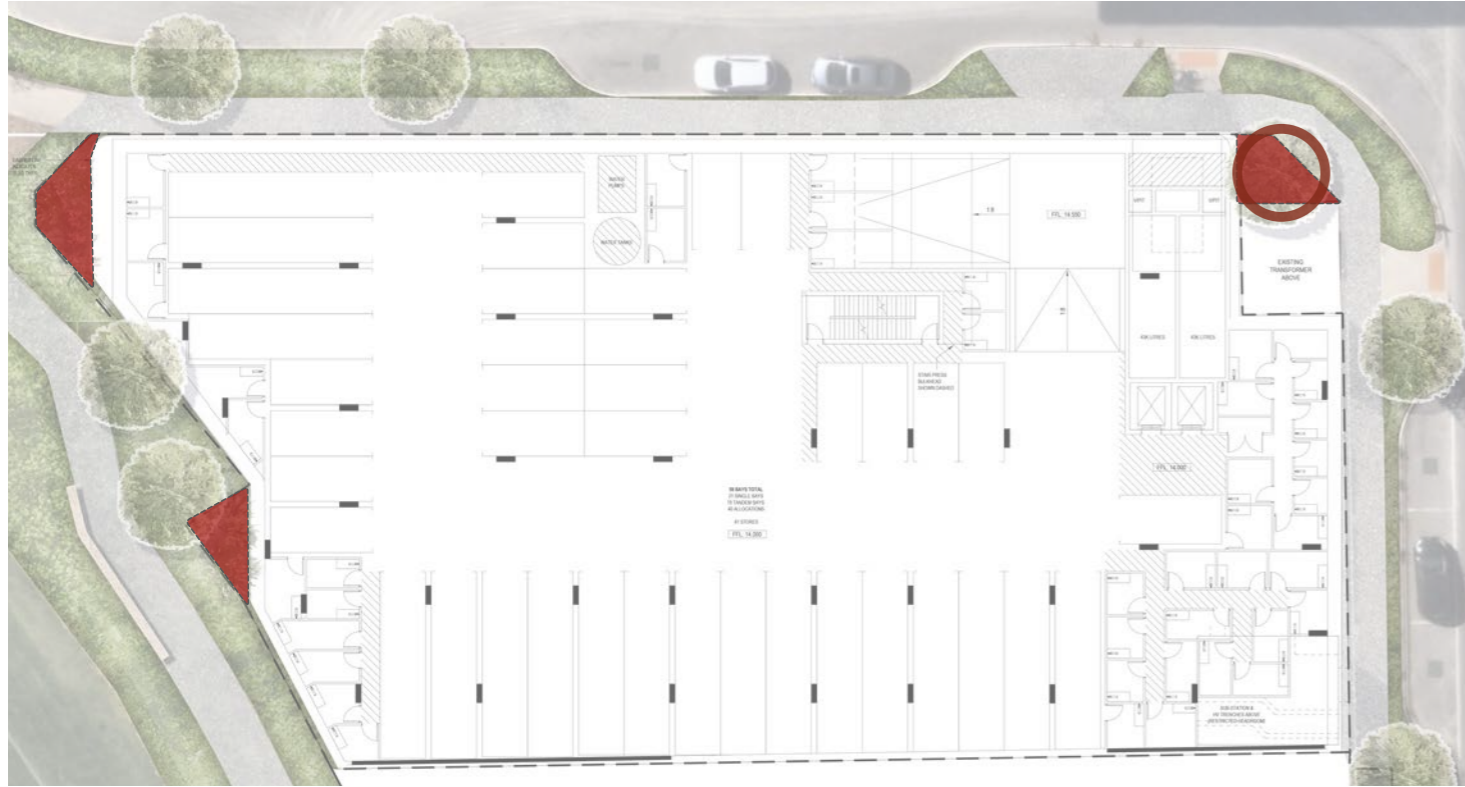

BASEMENT LEVEL

- DEEP SOIL IN GROUND 39 SQ.M
- SMALL TREE 1 NO.

LEVEL 1

- PLANTING ON STRUCTURE 60 SQ.M
- SMALL TREE 4 NO.



GROUND FLOOR

- PLANTING ON STRUCTURE 3.9 SQ.M

CLAREMONT TERRACES STAGE 2

PREPARED FOR HILLAM ARCHITECTS

LANDSCAPE CONCEPT
MARCH 2026

JOB NO. 2514601 C1.1019

REV E

COPYRIGHT THIS DOCUMENT IS AND SHALL REMAIN THE PROPERTY OF PLAN E

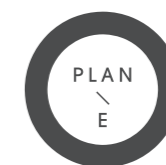

LANDSCAPE ARCHITECTS

LEVEL 1 278 RAILWAY PARADE WEST LEEDERVILLE 6007
T: (08) 9388 9566 E: mail@plane.com.au

05

DEEP SOIL & TREE CANOPY PROVISION COMPLIANCE LEVEL 2 & ROOF TOP LEVEL

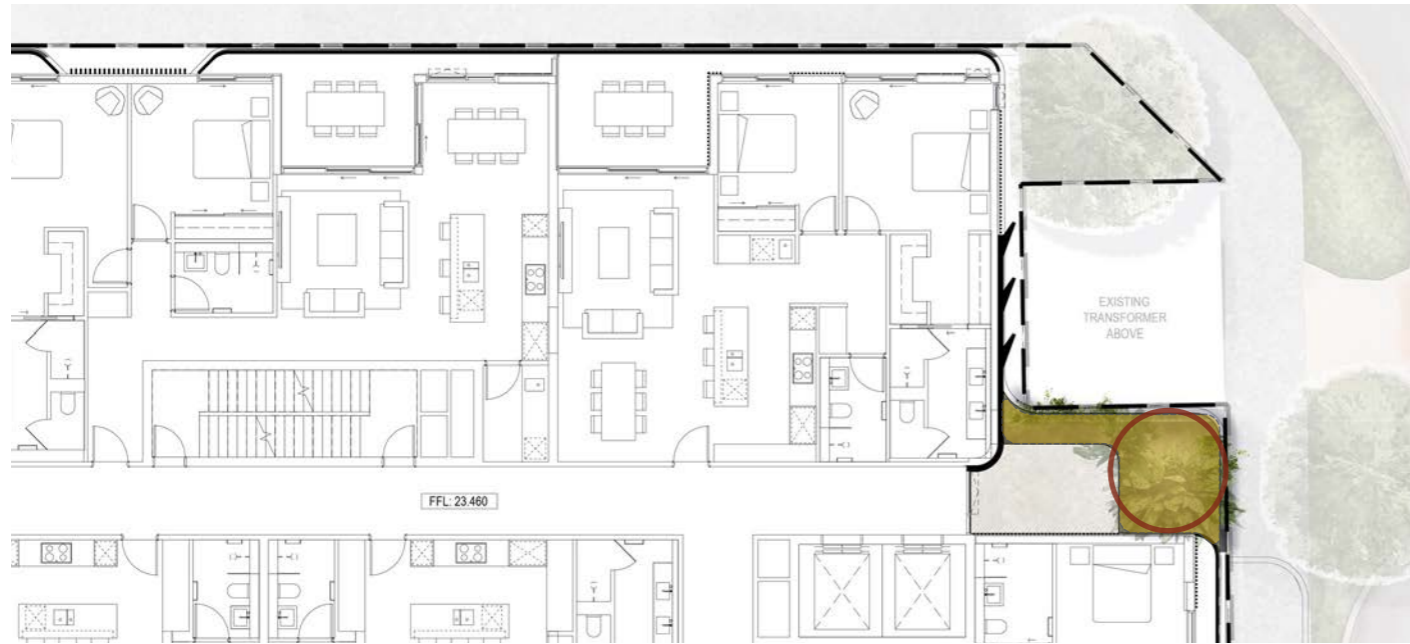

LEVEL 2

- PLANTING ON STRUCTURE 11 SQ.M
- SMALL TREE 1 NO.



ROOF TOP LEVEL

- PLANTING ON STRUCTURE 158.6 SQ.M
- SMALL TREE 13 NO.

FIGURES SHOWING DEEP SOIL REQUIREMENTS FOR TREES (AS PER SPP 7.3 DESIGN GUIDELINES)

CLAREMONT TERRACES STAGE 2

PREPARED FOR HILLAM ARCHITECTS

LANDSCAPE CONCEPT
MARCH 2026

JOB NO. 2514601 C1.1020

REV E

COPYRIGHT THIS DOCUMENT IS AND
SHALL REMAIN THE PROPERTY OF
PLAN E

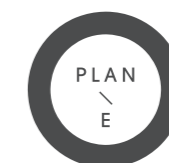

LANDSCAPE ARCHITECTS

LEVEL 1 278 RAILWAY PARADE WEST LEEDERVILLE 6007
T: (08) 9388 9566 E: mail@plane.com.au



LANDSCAPE ARCHITECTS

LEVEL 1 278 RAILWAY PDE WEST LEEDERVILLE WA 6007
T: (08) 9388 9566 E: mail@plane.com.au

CLAREMONT TERRACES STAGE 2

PREPARED FOR HILLAM ARCHITECTS
NOVEMBER 2025

2514601 CLAREMONT TERRACES STAGE 2

PLAN E